

INTERIOR WAYFINDING MAP

LEVEL 1

TEMPERANCE AVE.



HERNDON AVE.

LEVEL 1

BED TOWER

- 1 ICU Rooms 2101-2124
- 2 Step Down Rooms 3101-3130

OUTPATIENT CARE CENTER

- 3 Lab
- 4 Endoscopy Center
- 5 Marjorie E. Radin Breast Care Center
- 6 Evert's Bistro
- 7 Non-Stress Testing
- 8 Heart & Lung Institute / Surgical Pre-Admission Testing and Registration

MAIN HOSPITAL

- 9 Emergency Department
- 10 Ambassador Desk
- 11 Labor & Delivery Triage
- 12 Labor & Delivery Rooms 1101-1116
- 13 Radiology
- 14 Gift Shop
- 15 Grove Cafe
- 16 Supply Chain Management, Bio-Med & EVS
- 17 Chapel



ClovisCommunity.org

INTERIOR WAYFINDING MAP

LEVEL 2

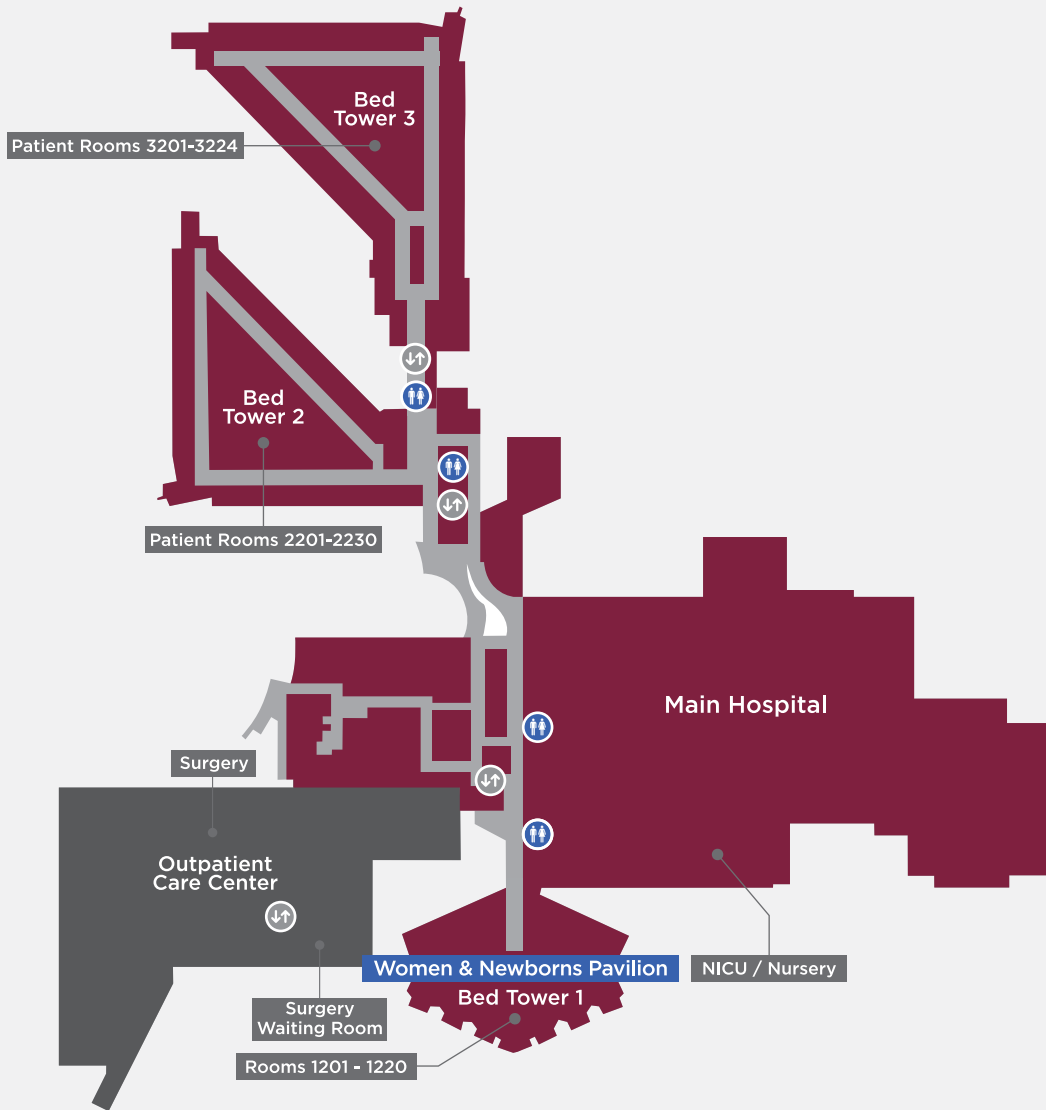

LEVEL 3

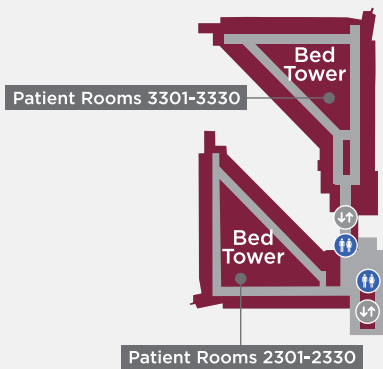

LEVEL 4

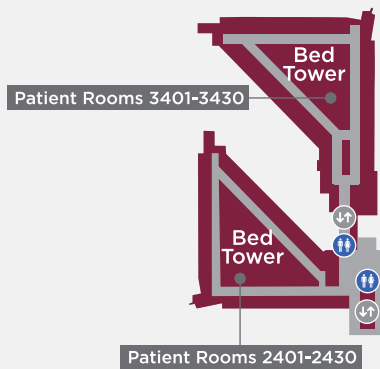

LEVEL 5

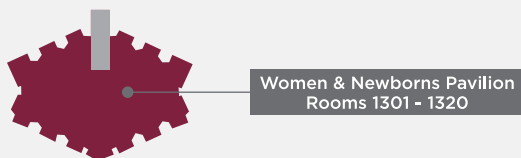
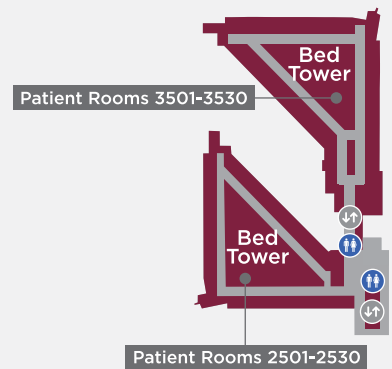

- ELEVATORS
- RESTROOMS